

FITTING INSTRUCTIONS - Inset Sink

NOTE: TO ENSURE CORRECT FITTING OF YOUR SINK, PLEASE READ THESE INSTRUCTIONS CAREFULLY BEFORE STARTING.

ITEMS REQUIRED: SPIRIT LEVEL, PENCIL, RULE, DRILL, JIG SAW, BLADE, SCREWDRIVER, BRUSH, SILICONE SEALANT, DAMP CLOTH
IF EARTHING A STAINLESS STEEL SINK YOU WILL ALSO NEED: M6 NUT, BOLT & LOCK-WASHERS, PLUMBER'S GRIPS OR SHIFTING SPANNER.

STEP 1

CHECK WORKTOP

Check worktop is flat, as shown.

(Items required: spirit level)

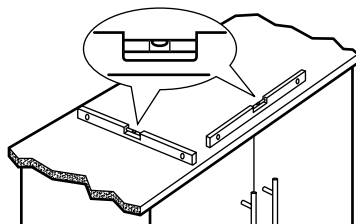

STEP 2

POSITION SINK

Place sink upside down on worktop and adjust to chosen position. It is important to make sure that the bowl will be clear of the cabinet when the sink is fitted. Once you are happy with the sink's position, mark round the outside edge with a pencil.

(Items required: pencil)

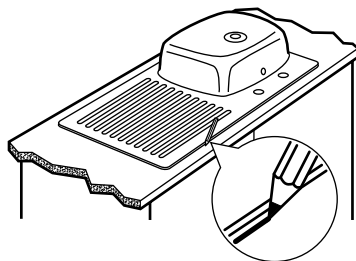

STEP 3

MARK WORKTOP

Remove sink from worktop. Measure 8mm inside the pencil line and draw another line all the way around.

(Items required: pencil and rule)

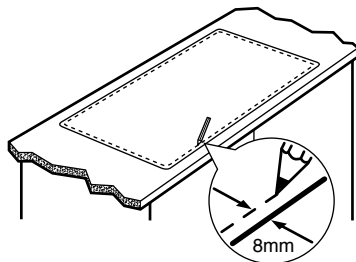

STEP 4

CUT OUT WORKTOP

(1) Drill a hole on the **inside line**, large enough to take a jig saw, then (2) carefully cut out the rectangular shape.

(Items required: drill and jig saw)

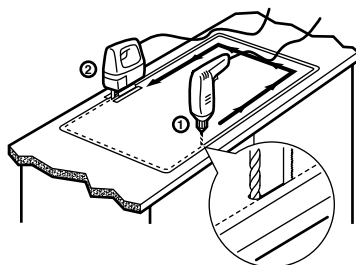

STEP 5

SEAL CUT-OUT

It is important to seal the exposed cut edges with a suitable sealant such as varnish, gloss paint or silicon before fitting the sink. Sealant brushed into the cut edges will prevent water swelling the worktop. A bead of silicone should also be applied around the full sink perimeter.

(Items required: brush and sealant)

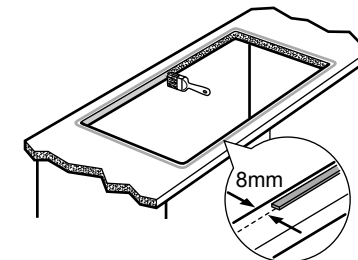

STEP 6

ATTACH CLAMPS

Remove the clamps from the plastic bag. With the sink upside down position the clamps around the edge of the sink. Before attaching clamps, make sure the claws are facing the outside of the sink, i.e. away from the bowl. Push the head of the clamp down onto the rail in line with the square cut-out slots (1), and at the same time turn the clamp to ease the head through the slot (2).

(Items required: none)

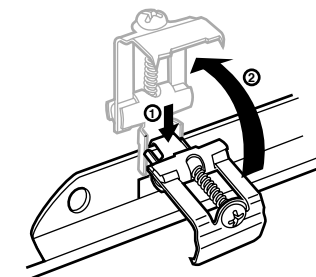

STEP 7

EARTHING (STEEL SINKS ONLY)

You must earth a stainless steel sink. There are round holes on each corner of your sink rail or in the corner of the bowl to enable you to do this. Select a hole which will be at the back of your sink when it is fitted. From the outside slip an M6 bolt with a washer through the selected hole and attach the nut and lock-washer on the inside.

Note: It is important that this is carried out prior to fitting the stainless steel sink.

(Items required: M6 nut, bolt & washers)

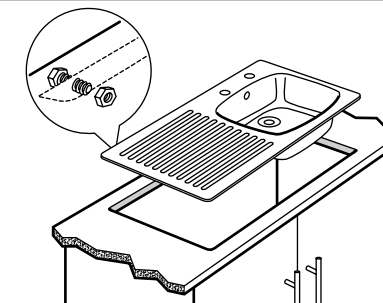

STEP 8

FIT SINK

Carefully drop the sink into the worktop cut-out. If applicable, attach and secure earth cable using the nut and bolt. Tighten the clamp screws to fix the sink securely to the worktop.

Note: do not use a power driver on high power as this may damage the sink.

Finally, wipe any excess silicone sealant from around the sink edge with a damp cloth.

(Items required: damp cloth, screwdriver and, if sink to be earthed, pair of plumber's grips or shifting spanners)

